

Front view

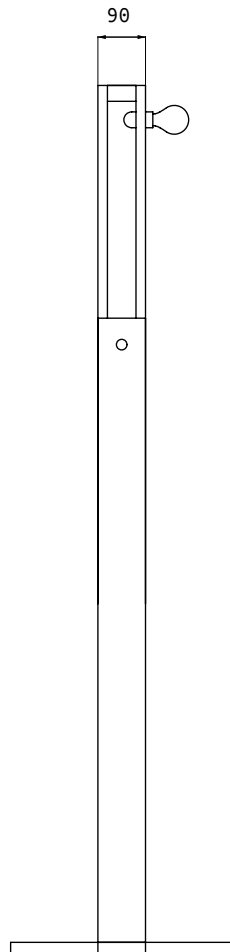

Side view 1

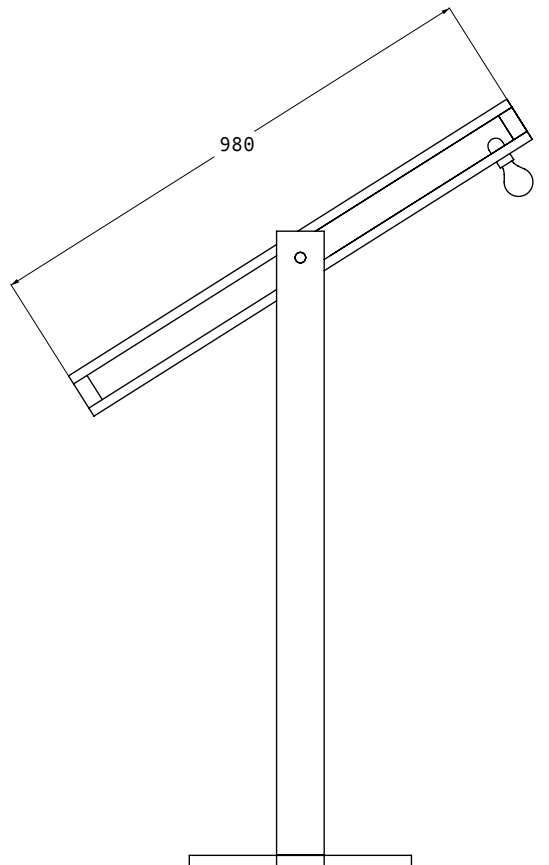

Side view 2

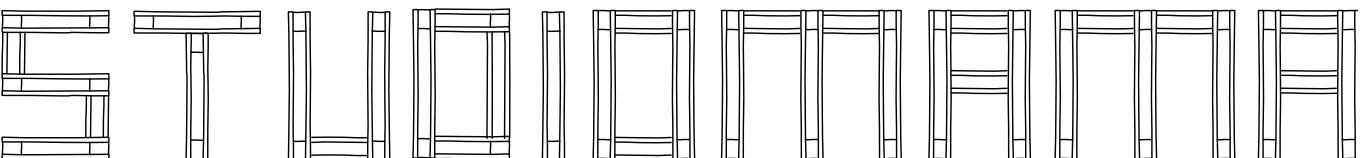

## INTRODUCTION

Most pallet manufactures are committed to recycle the pallets and keeping wooden packaging out of our landfills. I nevertheless see a huge amount of pallets abandoned in the streets of London every day.

The pallet market is becoming a significant element in UK and European distribution and this seems to be reflected in our environment. A recent study claimed that

"...the market capacity in the UK is 120,000 pallets a night..." (KPMG).

The market growth rate too is displaying some startling characteristics with recent annual growth rates claimed varying from 20% to 40%.

This lead me to choose to work with wooden pallets for my 10, TEN, X project and I've been amazed by the possibilities of building all kind of furniture out of pallets. All for free - if you've got the time and a few essential tools.



## Different pallet designs

A pallet seems to come in many different sizes and designs but I have found that the two main designs are Stringer design and Block design. See illustration.

The Stringer pallets are easier to get apart and I prefer them to the Block design - unless you are going to use the blocks.

## PRINCIPAL PARTS OF WOODEN PALLETS

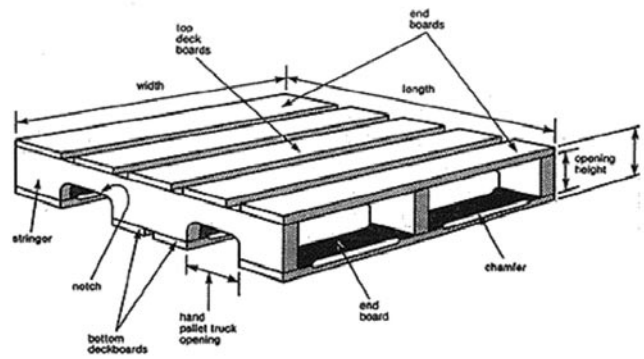

Stringer Design

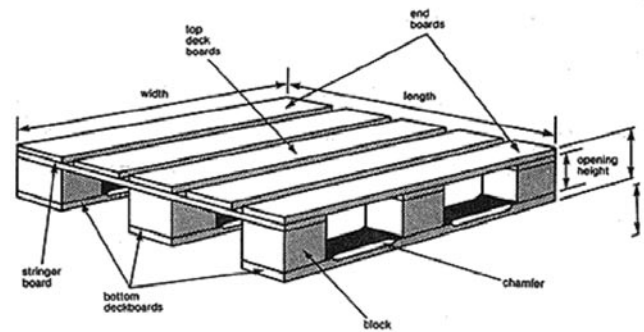

Block Design

## Tips

When you pick your pallets - take the pallets with as few nails in as possible. There will be some waste as some of the boards often get damaged when you take the pallets apart.

## TOOLS

Essential tools to take the pallets apart are a big crow bar and a heavy duty hammer. When making the piece of furniture any kind of electrical jigsaw, mitre saw or table saw are handy to have - but a good old fashioned saw will also do the job.

MAKING YOUR LAMP  
STEPS 1-6 OVERVIEW

1. Find a pallet. You need to find one of the longer pallets with planks about 1.2m.
2. Take the pallet apart. This can be a bit of struggle but I always find that my big crowbar does the job.
3. Cut all the elements needed to size. As shown in drawing 1
4. Make preparation to cut the elements. As shown in drawing 2

5. Make sure you have all the accessories needed to finish the lamp:

- 1 X 5" bolt and matching wing nut
- 12 X twin thread wood screws 6 X 1.1/4"
- 3 X twin thread wood screws 10 X 2" To fit foot to lamp.
- 2.5m cable (or longer if needed). If possible find a nice clear or round twisted silk braid wrapped flex.
- A light bulb fitting. Try to find an old fitting not a shiny new plastic one.
- A clear light bulb 60-100W.

6. You can now assemble the lamp following the assembly illustrations. (page 6).

For more information on this and other products visit [studiomama.com](http://studiomama.com) or email [tolstrup@studiomama.com](mailto:tolstrup@studiomama.com)

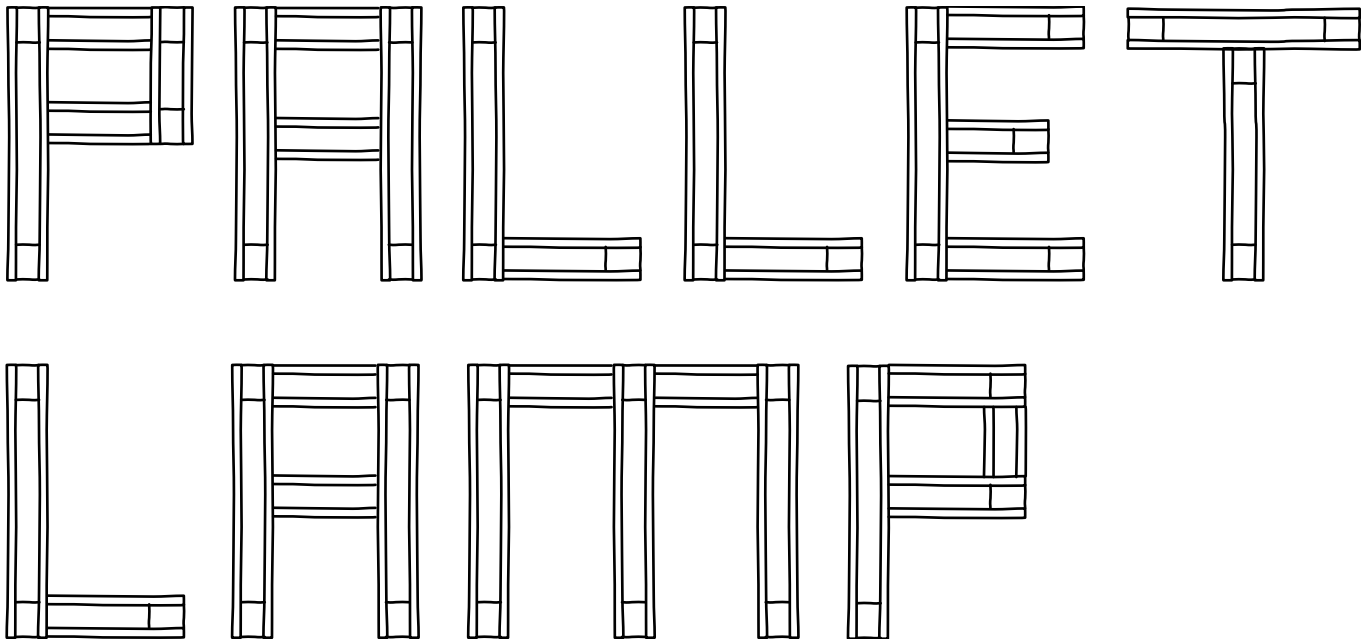

DRAWING 1

Cut up the following elements from pallets

2 x (18x90x1180mm planks)

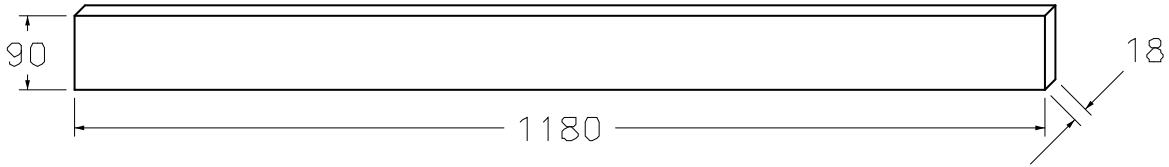

2 x (18x70x980mm planks)

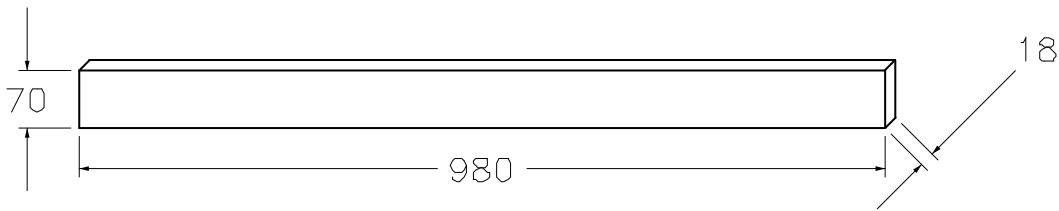

2 x (18x420x90mm plank)

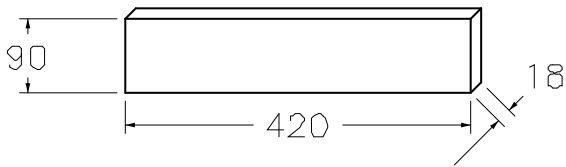

1 x (50x70x90mm foot block)

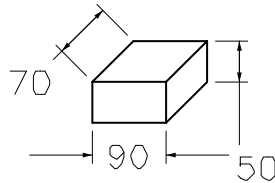

2 x (60x70x30mm end arm blocks)

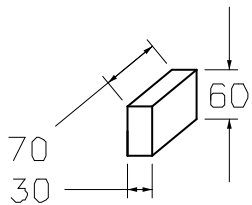

1 x (60x70x50mm mid arm block)

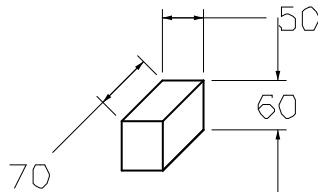

## DRAWING 2

Make the following preparation to the wood elements before assembly

1 x (18x70x980mm plank)

Cut a hole through the plank centred 65mm down from the top. The hole has to be about 33mm - but check the size of your bulb fitting

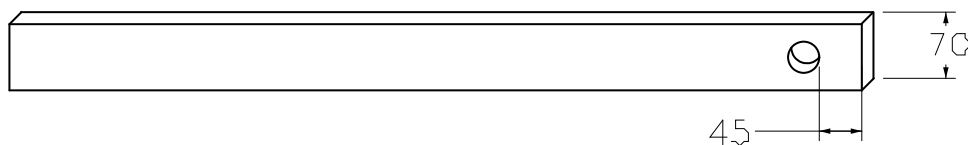

2 x (18x90x1180mm planks)

Cut a 5mm hole (drill bit no. 7/32 ) hole through the plank centred 50mm down from the top. drill out an inserted hole 6mm into the surface, so the wing screw sits slightly inserted on the plank.



2 x (18x420x90mm planks)

Chisel out centred on the plank 9 x 100mm so the two parts fits together like a Christmas tree foot.

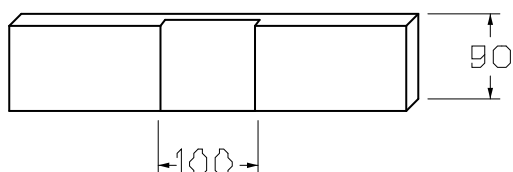

1 x (60x70x50mm mid arm block)

Drill a 5mm hole through the block, centred at the side 50x60mm. Use the same drill to make a hole below center on the long side 70x60mm of the block to run the cable through.

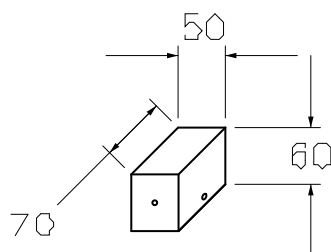

1 x (60x70x30mm end arm block)

You will also need to drill a 5mm cable hole below center on 60x70mm side of the end block opposite the light bulb end.

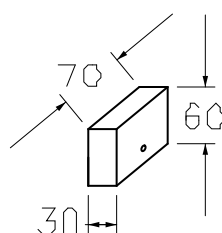

ASSEMBLY INSTRUCTIONS

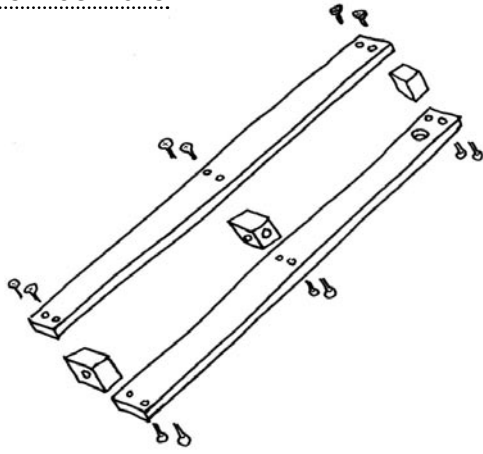

1. Start by screwing the arm part of the lamp together.

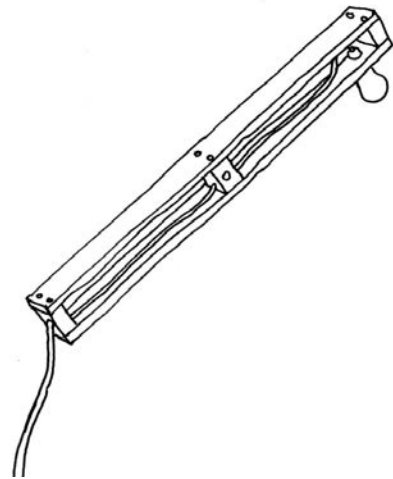

2. Run the cable and fix the light bulb fitting.

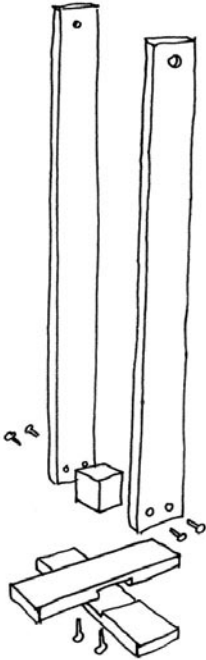

3. Screw together the lamp foot and the upright planks.

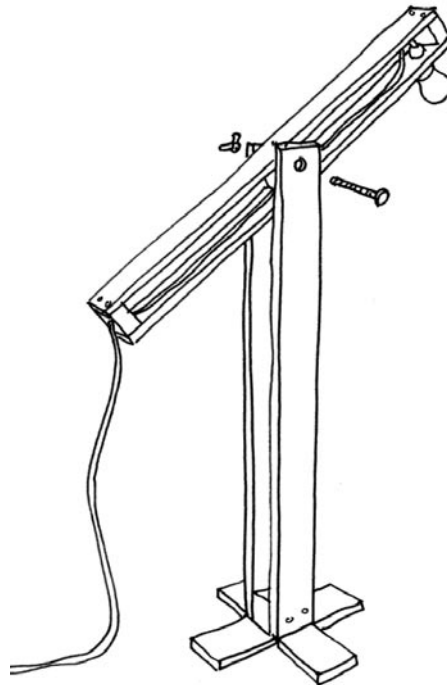

5. Fit the light bulb and the lamp.

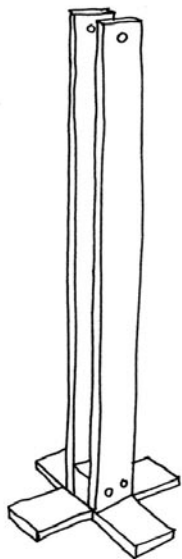

4. You can now fit the upright and the arm together with the 5" bolt and wing nut.

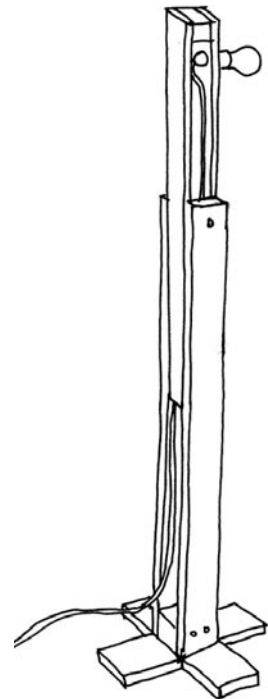

6. Give the wood a sanding with a coarse sandpaper. Finished!